

HASTINGS ROAD

BRIGHTON





KENDRICK PROPERTY SERVICES



Kendrick Property Services are delighted to bring to market this Garden apartment located in the heart of Brighton. Upon entering through the hallway you are greeted with a bright and spacious living room had that has large windows, allowing natural light to flow through. Also off the hallway is a good sized double bedroom that has plenty of storage as well as another large window. To the rear of the property is a bathroom, which is rare for a flat and a kitchen that leads to the rear garden. The well presented garden is ideal for the warmer months and is perfect for summer bbq's with friends and family.

Situated in this highly sought after residential area with an excellent variety of local shopping available at Lewes Road and with the Sainsbury's supermarket also within easy reach. There is a regular bus service available close-by and the beautiful Queens Park less than one mile. The North Laines and Brighton City Centre with its comprehensive shopping facilities and seafront being approximately one mile away too.

Hastings Road is an ideal first time buy and comes with a share of freehold.



KENDRICK PROPERTY SERVICES



Approximate Area = 458 sq ft / 42.5 sq m

For identification only - Not to scale

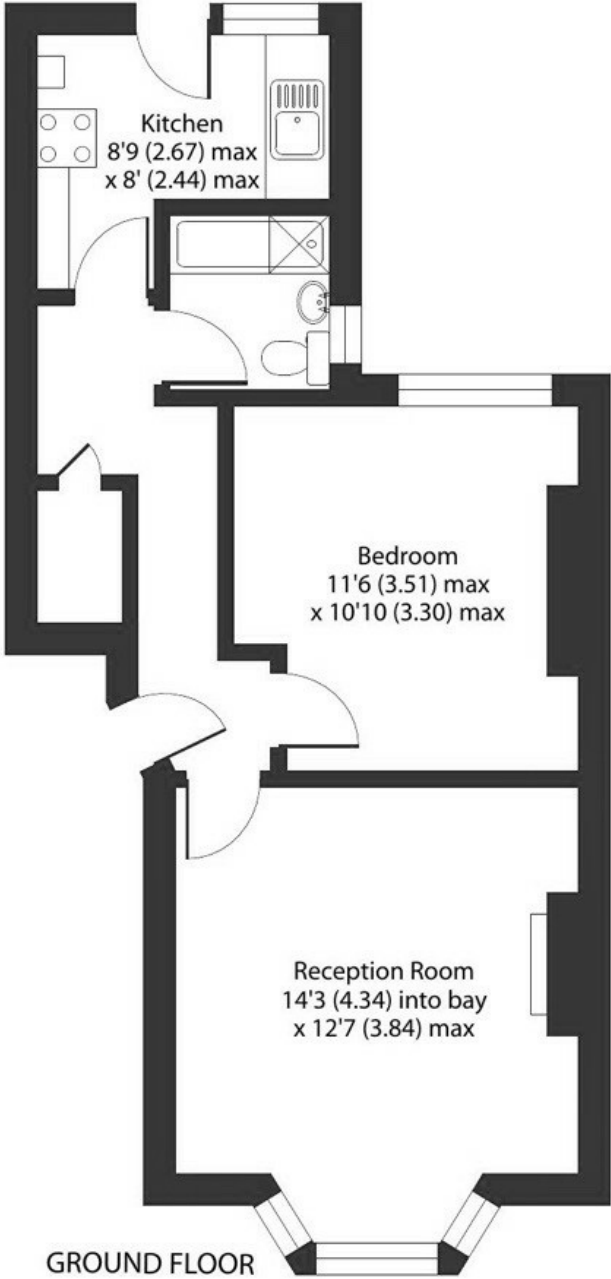

GROUND FLOOR



10 - 12 Lewes Road, Brighton, BN2 3HP

01273 600162

sales@kendrickpropertyservices.co.uk



A. These sales and particulars do not constitute any part of an offer of contract, and are for the guidance of prospective purchasers only and should not be relied on as statements of fact.

B. No representations are made in these particulars as to the condition of the property or as to whether any service or facilities are in good working order.

C. All measurements are approximate.